

## FRIALEN® Safety Fittings

**WS11** I/A Elbows 11°

PE 100 SDR 11

Maximum working pressure 16 bar (water)/10 bar (gas)

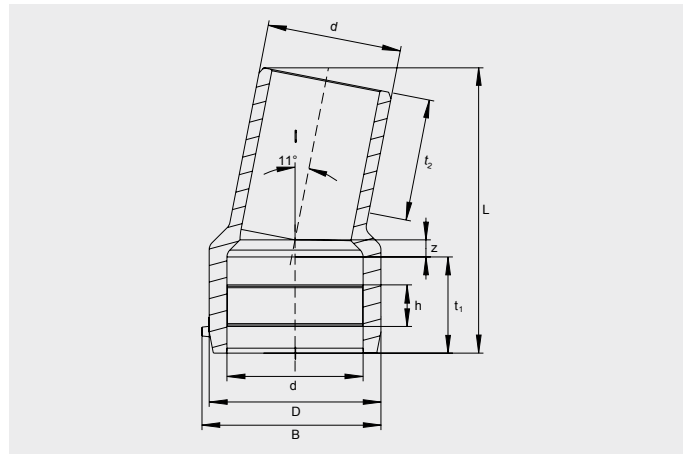

d	Order Ref.	Stock-status	BX	PU	D	L	t <sub>1</sub>	t <sub>2</sub>	z	h	B	Weight kg/each
110	616139	1	8	144	141	235	79	82.00	14	32	151	0.920
125	616140	1	5	90	160	250	84	87.00	15	34	168	1.250
160	616141	1	8	64	200	295	93	98.00	20	50	206	2.260
180	616142	1	4	32	226	310	100	105.00	22	50	230	3.050
225	616143	1	1	18	280	350	114	120.00	24	50	284	5.280

FRIALEN Safety Fittings can be fused to pipes of SDR stages 11 to 17.6. Other SDR-stages on request. Please observe the marking directly at the product, which is mandatory. DVGW Registration No.: DV-8606AU2249.

## FRIALEN® Safety Fittings

### WS11 I/A Elbows 11°

#### Areas of Application

The FRIALEN Elbow WS 11° is designed for universal direction changes in HD-PE pipes even in restricted spaces. Multiple applications allow 22°, 33° etc ... elbows to be reached.

#### Assembly Instructions

Fusing the pipe ends to the FRIALEN Elbow WS 11° takes place by the FRIALEN fusing – leakproof and longitudinal strong. One of the pipe ends is inserted in the coupler side of the FRIALEN Elbow WS 11° and then fused, the other pipe end is connected and fused to a FRIALEN Coupler. The pipe ends are prepared (remove oxide skin and cleaning) according to the general installation instructions (see also „Assembly Instructions“ for „FRIALEN Safety Fittings for house connections and distribution pipes up to d 225“).

#### Good reasons for using the FRIALEN Elbow WS 11°:

- Universal direction changes due to multiple applications 11°/22°/33° or 45° + 11° ...
- Maximum flexibility in case of obstructions and in restricted spaces due to coupler/spigot design
- Long insertion depth of coupler for optimum pipe guidance (no holding device required)
- Extra wide fusion zone inside coupler
- Maximum stability due to large wall thickness
- Cold zones at the front and in the centre of the coupler
- Exposed heating coil for direct heat transfer to pipe
- Small annular gap resulting in optimum joining pressure in the fusion zone
- Contacts safe to touch
- Fusion indicator for visual fusion control
- Additional barcode for tracing back the underground fitting (Traceability-Coding)