

## FRIALEN® Safety Fittings

**W45 Elbows 45°**

PE 100 SDR 11

Maximum working pressure 16 bar (water)/10 bar (gas)

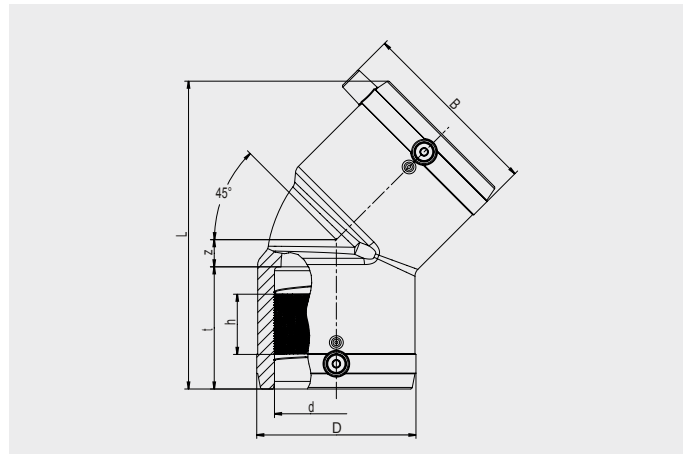

d	Order Ref.	Stock-status	BX	PU	D	L	t	z	h	B	Weight kg/each
25	616687 ①	1	150	2400	35	89	38	7	17	48	0.050
32	612092	1	50	1600	43	102	44	8	21	60	0.070
40	612094	1	30	960	54	120	49	11	29	70	0.110
50	612096	1	20	640	66	136	54	13	32	80	0.175
63	612098	1	10	320	82	158	62	14	34	95	0.295
75	612100	1	14	252	96	198	70	29	38	111	0.520
90	612102	1	8	144	115	232	79	35	45	128	0.810
110	612104	1	10	80	138	265	85	41	50	150	1.320
125	612106	1	10	80	157	279	87	46	44	167	1.770
160	615275	1	4	32	207	377	92	88	44	210	4.410
180	615687	1	3	24	228	382	97	83	65	229	4.610
200	616264	1	1	18	254	415	106	87	54	256	6.760
225	615688	1	1	8	280	450	112	98	66	281	8.290

① Design deviates from product description

FRIALEN safety fittings can be fused to pipes SDR11 - SDR 17.6. Minimum wall thickness  $s_{min} \geq 3$  mm. Other SDR-stages on request. Please observe the marking directly at the product, which is mandatory. DVGW-Registration Nos. DV-8601AU2248 and DV-8606AU2249

## FRIALEN® Safety Fittings

### W45 Elbows 45°

#### Areas of Application

The FRIALEN-Elbow W45° is used for all changes of direction in HD-PE pipes.

#### Assembly Instructions

The fusion of the pipe ends with the FRIALEN-Elbows W45° takes place by FRIALEN-fusing – leakproof and longitudinally strong.

The pipe ends are prepared according to the general installation instructions (see Assembly Instructions for FRIALEN-Safety Fittings for house connections and distribution pipes up to d 225). This involves removing the oxide skin and cleaning the pipe ends.

#### Good reasons for using the FRIALEN-Elbows W45°:

- Large coupler depth for ease of pipe guiding (no holding clamps required)
- Extra wide fusion zones
- Maximum stability through great wall thickness
- Cold zones at the front side and in the middle of the coupler
- Exposed heating coil for direct heat transmission to the pipe
- Small annular gap for build-up of optimum joining pressure in the fusion zone
- Contacts safe to touch
- Fusion indicator for visual fusion control
- Durable batch marking
- Individually wrapped for dirt protection
- Additional barcode for tracing back the fitting (Traceability-Coding)