

FRIALEN® SAFETY FITTINGS

SPAK CAP FOR SHUT OFF SADDLES

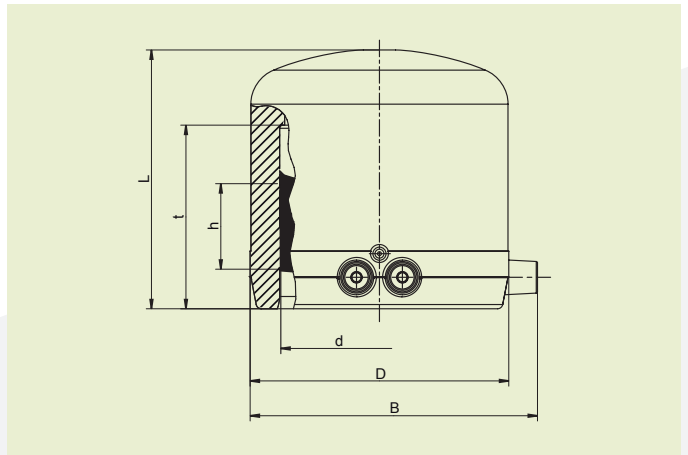

PE 100 SDR 11

Maximum working pressure 16 bar (water)/10 bar (gas)



d	Order Ref.	Stock-status	BX	PU	D	L	t	h	B	Weight kg/each
75	612311	1	20	640	99	99	70	31	110	0,280

FRIALEN-Safety Fittings can be fused to pipes of SDR stages 11 to 17.6. Other SDR-stages on request. Please observe the marking directly at the product, which is mandatory. DVGW-Registration No.: DV-8606AU2249

FRIALEN® SAFETY FITTINGS

SPAK CAP FOR SHUT OFF SADDLES

Areas of Application

FRIALEN-Cap SPAK is used for final sealing of the drill socket (dome) of a Shut off Saddle SPA \geq d 90 or SPA-TL. Also suitable as End Cap MV for d 75.

Assembly Instructions

The fusion of the Dome of a FRIALEN-Shut off Saddle with the FRIALEN-Cap SPAK takes place by FRIALEN-fusing – leak-proof and longitudinally strong.

The dome has to be prepared according to the general installation instructions (see “Assembly Instructions” for “FRIALEN-Safety Fittings for house connections and distribution pipes up to d225”). This involves removing the oxide skin and cleaning the pipe ends.

Good reasons for using the FRIALEN-Cap for Shut off Saddle SPAK:

- Large insertion depth for ease of pipe guiding
- Extra wide fusion zones
- Maximum stability through great wall thickness
- Cold zones at the end to prevent the flow of molten material
- Exposed heating coils for optimal heat transfer to the pipe
- Small annular gap for build-up of optimum joining pressure in the fusion zone
- Contacts safe to touch
- Fusion indicator for visual fusion control
- Durable batch marking
- Individually wrapped for dirt protection
- Additional barcode for tracing back the fitting (Traceability-Coding)