

## FRIALEN® SAFETY FITTINGS

### SAFL SPIGOT SADDLES WITH FLANGE OUTLET

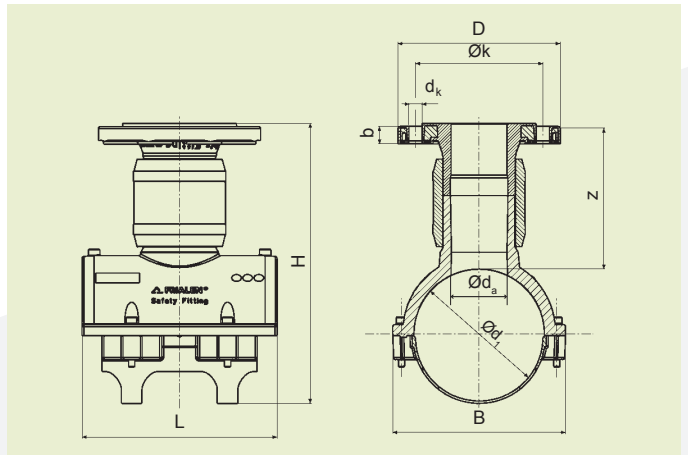

**PE 100 SDR 11**

**Maximum working pressure 16 bar (water)/10 bar (gas)**



d <sub>1</sub> /DN	Order Ref.	Stock-status	BX	PU	D	L	B	d <sub>k</sub>	Z	Ø k	H	Holes for screw	b	Drilling Ø d	Weight kg/each
110/80	616016	1	3	54	204	190	165	16.5	180	160	296	8	25	65	3.700
125/80	616017	1	2	36	204	205	185	16.5	180	160	311	8	25	65	3.940
160/80	616018	1	2	36	204	245	217	16.5	180	160	346	8	25	65	4.320
180/80	616019	1	2	36	204	285	241	16.5	180	160	366	8	25	65	4.610
225/80	616020	1	2	16	204	284	286	16.5	180	160	411	8	25	65	4.720
125/100	616021	1	2	36	224	205	185	16.5	180	180	311	8	27	84	4.770
160/100	616022	1	2	36	224	245	217	16.5	180	180	346	8	27	84	5.270
180/100	616023	1	2	36	224	285	241	16.5	180	180	366	8	27	84	5.520
225/100	616024	1	2	16	224	284	286	16.5	180	180	411	8	27	84	5.635

FRIALEN-Safety Fittings can be fused to pipes of SDR stages 11 to 17.6. Other SDR-stages on request. Please observe the marking directly at the product, which is mandatory. DVGW-Registration No.: DV-8606AU2249

## FRIALEN® SAFETY FITTINGS

### SAFL SPIGOT SADDLES WITH FLANGE OUTLET

#### Areas of Application

The FRIALEN Spigot Saddle with Flange Outlet SAFL is used for the integration of flange valves and hydrants up to PN 16.

#### Assembly Instructions

The saddle of the SAFL is mounted and fused onto the HD-PE mains. Drilling into the HD-PE mains can take place

- without pressure in the mains
- under operating pressure on application of a gate-valve on the flange side

using standard drill equipment. We recommend Hütz + Baumgarten.

The fusion of the saddle piece with the HD-PE mains takes place using FRIALEN-fusion –leakproof and longitudinally strong. Saddle and HD-PE mains are prepared according to the general installation instructions (see Assembly Instructions for “FRIALEN-Safety Fittings for house connections and distribution pipes up to d 225”). This involves removing oxide skin.

The flange connection measurements correspond to DIN EN 1092-1. Supplementary washers are required.

All standard profile and flat gaskets can be used. Torques advised by the gasket manufacturer must be observed. We recommend profile gaskets of type G-St.

#### Good reasons for using the FRIALEN-Spigot Saddle with Flange Outlet SAFL:

- Compact component from HD-PE
- Flange adaptor and flange are one component. They make up one homogeneous unit
- Factory made combination of FRIALEN-Spigot Saddle, FRIALEN-Coupler and Full Faced Flange
- Smooth on the inside and no fusion bead at the connection between SA and EFL, optimum hydraulics
- The cold flowing properties well known with HD-PE are avoided by constructive flange design
- Solid construction. Integration of the flange prevents tear-off
- Short overall length for horizontal and vertical installation
- Top stability due to great wall thickness
- Extremely economical solution
- Additional barcode for tracing back the underground fitting (Traceability-Coding)