

FRIALEN® SAFETY FITTINGS

RS REINFORCING SADDLE

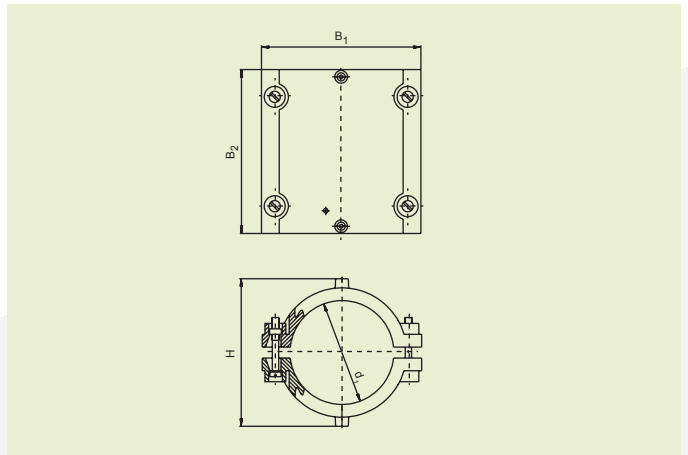

PE 100 SDR 11

Maximum working pressure 16 bar (water)/10 bar (gas)



d_1	Order Ref.	Stock-status	BX	PU	H	B_1	B_2	Weight kg/each
63	612519	1	20	360	105,5	105	104	0,260

FRIALEN-Safety Fittings can be fused to pipes of SDR stages 11 to 17.6. Minimum wall thickness $s_{min} \geq 3$ mm. Other SDR-stages on request. Please observe the marking directly at the product, which is mandatory.

DVGW-Registration No.: DV-8601AU2248

FRIALEN® SAFETY FITTINGS

RS REINFORCING SADDLE

Areas of Application

The FRIALEN-Reinforcing Saddles are used for the repair of minor pipe damage with no escape of fluid, especially to reinforce crushed zones and points with external damage.

Assembly Instructions

The fusion of the HD-PE pipe with the FRIALEN-Reinforcing Saddles takes place by FRIALEN-fusing – leakproof and longitudinally strong.

Both HD-PE saddles have to be prepared according to the general installation instructions (see “Assembly Instructions” for “FRIALEN-Safety Fittings for house connections and distribution pipes up to d 225”). This involves removing the oxide skin and cleaning the pipe covered by the saddles.

Good reasons for using the FRIALEN-RS:

- Compact construction
- HD-PE saddle with exposed heating element for optimal heat transfer
- Preassembled unit without loose parts
- Extra wide fusion zone
- Additional barcode for tracing back the underground fitting (Traceability-Coding)