

FRIAFIT® Sewage Saddle Top-Loading ASA-TL

for connection of waste water domestic pipes to HDPE sewers,
for FRIAFIT®-fusion of HDPE pipes SDR 33 – SDR 11
PE 100

Maximum testing pressure 0,5 bar (according to DIN EN 1610)

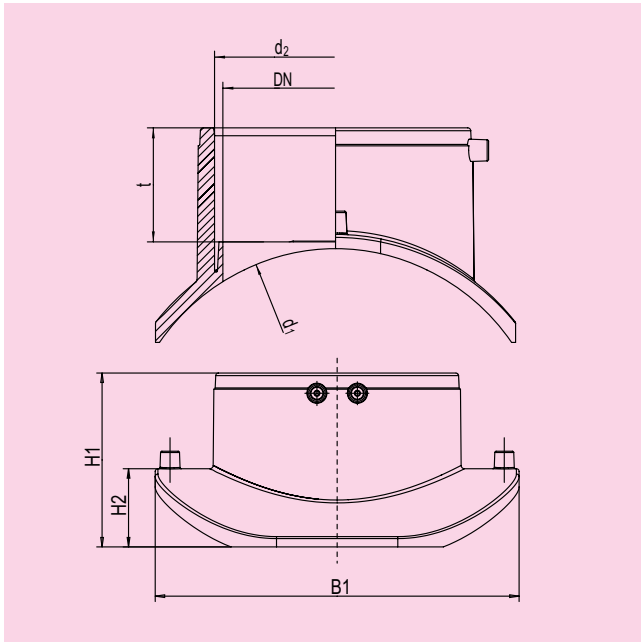

| d1 | d2 | Order Ref. | Stock-status | BX | PU | DN | B1 | B2 | H1 | H2 | t | Weight kg/each |
|-------------|-----|---------------|--------------|----|----|-----|-----|-----|-----|----|----|----------------|
| 200 | 160 | 682618 | 1 | 8 | 64 | 150 | 270 | 210 | 163 | 92 | 76 | 1,000 |
| 225 | 160 | 682613 | 1 | 8 | 64 | 150 | 270 | 230 | 165 | 94 | 76 | 1,050 |
| 250 | 160 | 682619 | 1 | 10 | 80 | 150 | 270 | 235 | 155 | 84 | 76 | 0,990 |
| 280 | 160 | 682614 | 1 | 10 | 80 | 150 | 270 | 240 | 143 | 72 | 76 | 0,990 |
| 315 | 160 | 682615 | 1 | 10 | 80 | 150 | 270 | 250 | 139 | 68 | 76 | 0,990 |
| 355 | 160 | 682620 | 1 | 10 | 80 | 150 | 270 | 255 | 129 | 58 | 76 | 0,990 |
| 400 | 160 | 682621 | 1 | 10 | 80 | 150 | 270 | 255 | 123 | 52 | 76 | 0,890 |
| 450 | 160 | 682616 | 1 | 10 | 80 | 150 | 270 | 255 | 117 | 46 | 76 | 1,020 |
| 500/560/630 | 160 | 682622 | 1 | 10 | 80 | 150 | 270 | 255 | 117 | 46 | 76 | 1,020 |

Assembly d 200 to pipes with SDR 33 - 11 and
d 225 - d 315 to pipes with SDR 33 - 26
please observe the FRIAFIT Assembly Instruction.

For the assembly on Close-Fit-Inliner and
d 560 and d 630 please contact our hotline +49 621/486-1896.

Please turn over for important information regarding FRIAFIT®-Sewage Saddle ASA-TL.

FRIAFIT® Sewage Saddle Top-Loading ASA-TL

for connection of waste water domestic pipes to HDPE sewers, for FRIAFIT®-fusion of HDPE pipes SDR 33 – SDR 11 PE 100

Maximum testing pressure 0,5 bar (according to DIN EN 1610)

Sewer systems represent high quality economic assets, and we need to maintain their value long term. Sewerage systems need to meet ever increasing demands and require raw materials which fulfil these conditions. For many years now the FRIAFIT®-Sewage System made from HDPE has connected HDPE sewer pipes leak-proof, longitudinal strong and root-bound with the aid of FRIAFIT® fusion technology.

Areas of Application

Domestic connections to HDPE sewers: These have up to now been carried out using spigot fittings which are connected to the pipe system with heating coil couplers. Retrospective connection to domestic pipes is only possible if the sewer pipe system is separated which is time consuming. The FRIAFIT®-Sewage Saddle ASA-TL allows to establish domestic sewer connections without having to separate the existing pipeline.



Picture: Clamping and Tapping Unit FWFIT

Assembly Instructions

The component is fixed onto the pipe using a separately supplied unit, **the Clamping and Tapping Unit FWFIT**, (see picture), and after the fusion process the pipe can be drilled gaplessly once the cooling time has been adhered to. Please refer to the FRIAFIT®-installation manual and the FWFIT-operating instructions for preparing the ASA-TL saddle for fusion.

Nine good reasons for using the FRIAFIT®-Sewage Saddle ASA-TL

- **Economic establishing of domestic connections, particularly in areas with high density of development**
- **Can be used with new installations, restoration and retrospective connections of sewer pipes**
- **Minimal space required due to the compact component design. Pipe connections from HDPE are fused directly into the integrated heating coil coupler of the outlet socket**
- **Direct integration of connecting pipes without misalignment or flow obstructions**
- **No further components required due to integrated heating coil coupler in the outlet**
- **The combined unit FWFIT for an economical finish of the sewage saddle.**
- **Barcode for fully automatic fusion process with HDPE pipes from SDR 33 to SDR 11 in view of the surrounding temperature (compensation of the temperature).**
- **Exposed, firmly embedded heating coil for an ideal heat transfer to the pipe.**
- **External leak tightness (external pressure) confirmed by an independent institute.**

For further information, please call our customer service staff and specialist advisers.

FRIATEC Aktiengesellschaft · Technical Plastics Division
P.O.B. 71 02 61 · D-68222 Mannheim
Telephone +49 621 486-1431 · Telefax +49 621 479196
www.friafit.com · info-friafit@friatec.de

Please find our datasheets for downloading on the internet at www.friafit.com