

## FRIALEN® SAFETY FITTINGS

### SPAI BALLOON SHUT OFF SADDLES

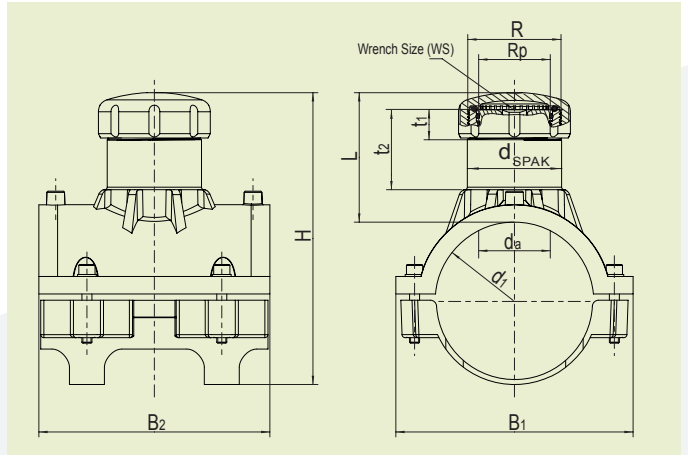

**PE 4710 SDR 11**  
Maximum working pressure 200 psi (water)/125 psi (gas)

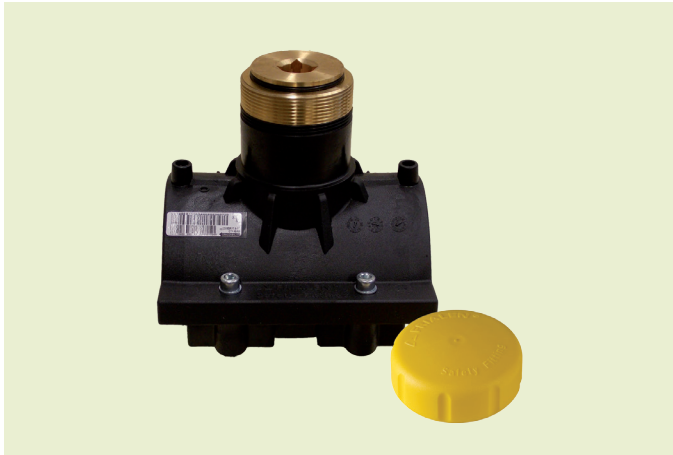

d <sub>1</sub>	R	R <sub>p</sub>	Order Ref.	Stock-status	BX	PU	L	t <sub>1</sub>	t <sub>2</sub>	d <sub>SPAK</sub> [mm]	H	B <sub>1</sub>	B <sub>2</sub>	WS [mm]	Drilling Ø d <sub>a</sub>	Weight kg/each
3 IPS	G 2 1/2"	G 2"	616565	2	16	128	4.094	0.945	2.520	75	7.712	6.142	5.906	19	2.224	1.380
4 IPS	G 2 1/2"	G 2"	616566	2	12	96	4.094	0.945	2.520	75	8.752	7.008	7.086	19	2.224	1.540
6 IPS	G 2 1/2"	G 2"	616567	2	8	64	4.094	0.945	2.520	75	10.846	9.055	7.677	19	2.224	1.860
8 IPS	G 2 1/2"	G 2"	616542	2	5	40	4.094	0.945	2.520	75	12.835	10.157	7.598	19	2.224	1.900
10 - 12 IPS	G 2 1/2"	G 2"	616568 ①	2	18	144	4.094	0.945	2.520	75		7.914	7.874	19	2.224	1.200

① Top-Loading version

FRIALEN Balloon Shut off Saddle SPAI can be fused to pipes of SDR stages 11 - 17.6.  
Other SDR stages on request. Please observe the marking directly at the product, which is mandatory.  
Approved according to ASTM F1055

Safe shut-off of gas flow using balloon technique.

**NOTE:**

Equipment for use as balloon shut off saddle must match with SPAI, in particular the function of driller, balloon setting and brass plug setting equipment. Note the manufacturer's instructions and application limits, especially the safety guidelines for working on gas pipes under operating pressure.

### SPAK CAP FOR BALLOON SHUT OFF SADDLES

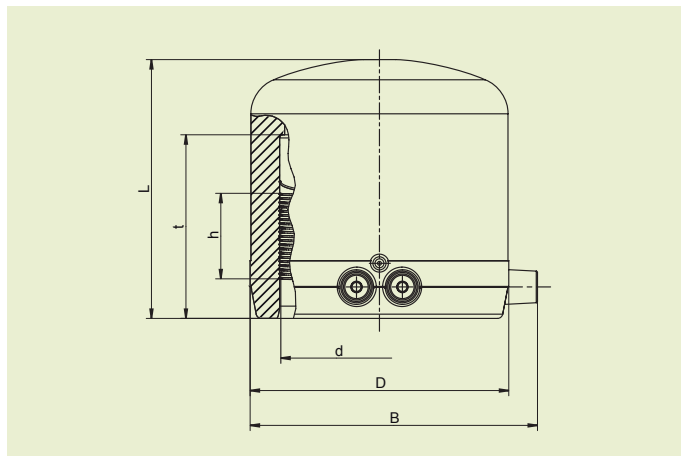

**PE4710 SDR 11**  
Maximum working pressure 200 psi (water)/125 psi (gas)



d [mm]	Order Ref.	Stock-status	BX	PU	D	L	t	h	B	Weight kg/each
75	612311	1	20	640	3.898	3.898	2.756	1.220	4.330	0,280

## FRIALEN® SAFETY FITTINGS

# **SPAI** BALLOON SHUT OFF SADDLES AND CAP FOR BALLOON SHUT OFF SADDLES SPAK

### Areas of Application

FRIALEN Balloon Shut off Saddles SPAI are suitable for blocking media by the use of commercially available shut off equipment or for vending/flushing.

The drill socket (stack) of a Balloon Shut off Saddle SPAI can be finally sealed with the FRIALEN Cap SPAK.

### Assembly Instructions

The fusion of the HD-PE main and the FRIALEN Balloon Shut off Saddle SPAI as well as the FRIALEN Cap SPAK takes place by FRIALEN-fusing – leakproof and durable.

The pipe, the saddle and the stack have to be prepared according to the general installation instructions (see “Assembly Instructions” for “FRIALEN-Safety Fittings for House Service and Supply pipings up to d 225). This involves removing the oxide skin, cleaning the pipe covered by the saddle and the stack end.

Note for the assembly of SPAI 10 - 12 IPS:

The saddle is clamped onto the pipe with the FRIATOP clamping device (see pricelist “Technical Equipment”). Please read the “Assembly and Operating Instructions for FRIATOP clamping unit (Top-Loading)”.

### Good reasons for using the FRIALEN Balloon Shut off Saddles SPAI and the FRIALEN Cap SPAK:

- Compact construction
- HD-PE Saddle and Cap with exposed heating element for optimal heat transfer
- Extra wide fusion zones
- Cold zones to prevent the flow of molten material
- Compact part available for commercially available balloon shut off equipment and for tapping of the main
- Long and solid brass-male thread for a safe connection of the shut off equipment
- Female brass insert with thread, permanently and tightly anchored in the HD-PE-stack
- Permanently sealed by brass threaded plug
- Includes brass plug with an inserted square
- Protection against access to the stack by fusing on a FRIALEN Cap SPAK
- ASTM approved
- Additional barcode for tracing back the installed fitting (Traceability-Coding)
- Contacts safe to touch
- Fusion indicator for visual fusion control
- Durable batch marking
- Individually wrapped for dirt protection